

ZAXIS-5G series

HITACHI

Reliable Solutions

ZAXIS

130/200/240

AMPHIBIOUS EXCAVATOR



Hitachi Construction Machinery Group

LANDCROS

Japanese Excellence — Reliable Solutions

APPLICATION ATTACHMENT

AMPHIBIOUS EXCAVATOR

Model code : ZX130-5G / ZX200-5G / ZX240-5G Amphibious
Engine rated power : 67 kW (90HP) / 125 kW (168HP) / 132 kW (177HP)
Operating weight : 25 100 kg / 33 700 kg / 42 600 kg
Bucket capacity : 0.35 m³ / 0.50 m³ / 0.75 m³

AMPHIBIOUS EXCAVATOR

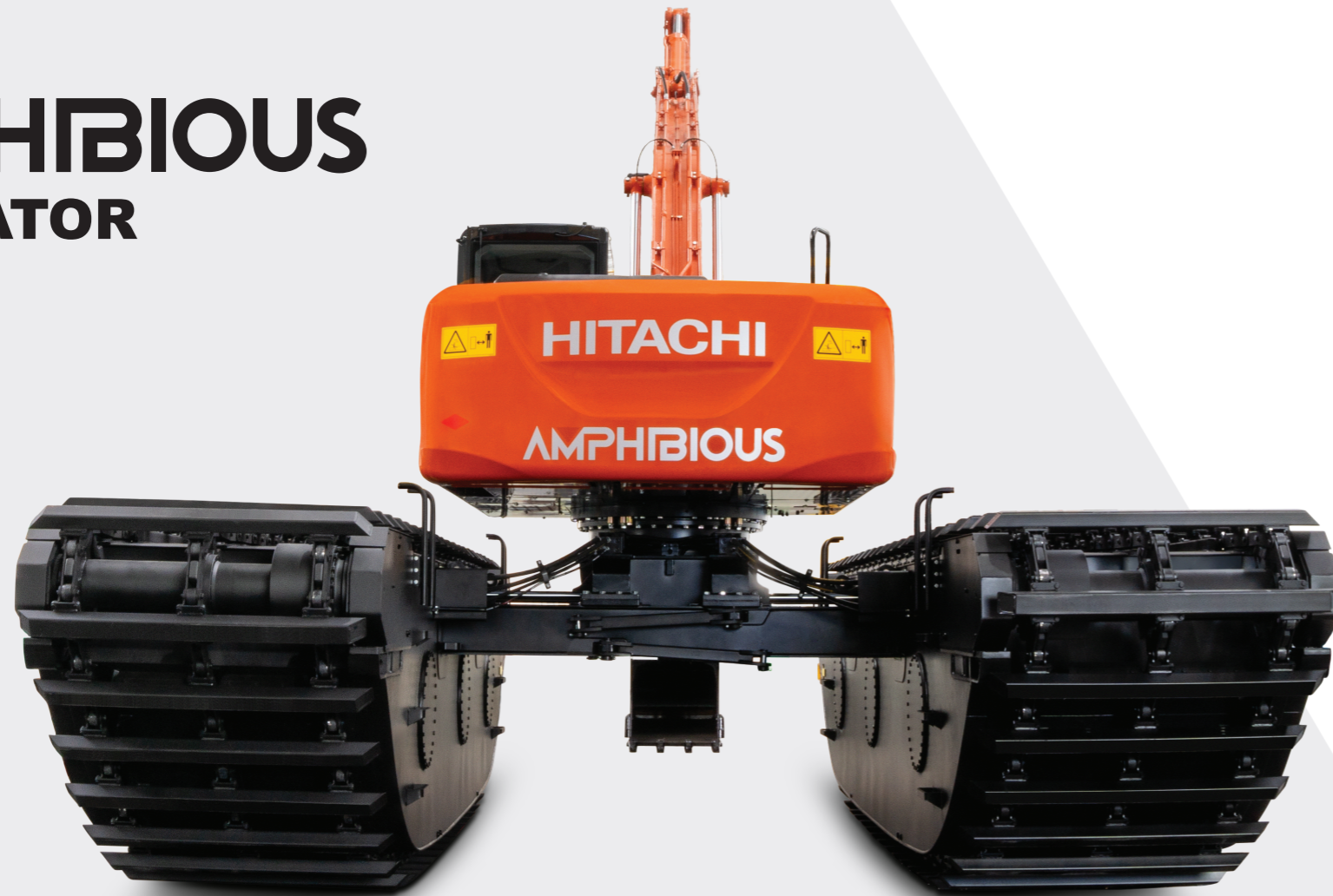

PONTOON UNDERCARRIAGE

FINAL DRIVE SYSTEM

- ▶ A breakthrough in final drive design, the 'multi-synchronous direct drive' hydraulic motor on each pontoon.
- ▶ Multiple active motors propelling each pontoon provide superior tracking power, making it virtually undeterred in any terrain.
- ▶ The drive system provides fulltime push-&-pull propelling power at both the front and rear of the pontoon.
- ▶ Increased in reliability. New motor supplier has strong track record for its Japan quality.
- ▶ The design provides superior trekking ability in swamps and soft terrain. Redundancy in design for emergency.

DESIGN MODULAR

- ▶ Transportation width reduced by 4-7% (model dependent)
- ▶ Floating capacity maintained.

Amphibious excavator is expertly crafted to navigate marshes, swamps, and soft terrains with ease, featuring the unique ability to float on water for added safety. Powered by our 'multi-synchronous hydraulic motor direct drive' system, this cutting-edge technology places us at the forefront of amphibious excavator innovation.

This revolutionary design has earned the trust of both new and experienced customers, transforming the industry's approach to amphibious machinery. Fully self-propelled, this machine can access even the most challenging soft terrains where traditional excavators cannot.

Proven time and again, this machine excels in a variety of applications, delivering exceptional performance on these applications :

APPLICATIONS :

- ▶ Maintenance and cleaning of waterways, lakes, shorelines, ponds, etc.
- ▶ Erosion control and prevention.
- ▶ Deepening of waterways and river deltas.
- ▶ Maintenance and repair of natural environment.
- ▶ Flood protection and flood maintenance works.
- ▶ Landscape building and protection.
- ▶ Accessing difficult strands of water/soft terrain.
- ▶ Swamp and wetland construction.
- ▶ Road building through wetlands.



HYDRAULICALLY EXTENDABLE

- ▶ Innovative technology of undercarriage allows each pontoon to extend outwardly via hydraulic function, providing the extra stability whenever the situation calls for.
- ▶ pontoons can be retracted to its narrow position during land transportation.
- ▶ Control functions can be executed comfortably with ease from the cabin.

AMPHIBIOUS EXCAVATOR

PROPRIETARY TECHNOLOGIES

ZX-5G Amphibious Undercarriage that has exclusive technology refers to innovation or a superior system that provides satisfaction for customers.

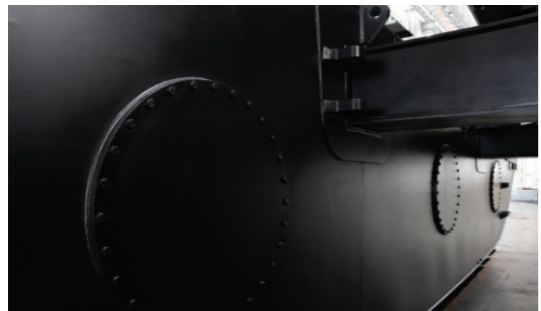

Each pontoon has two bulk heads, with three independent hermetically sealed compartments. Service manholes provide easy access to the interior of the pontoon for preventive maintenance.

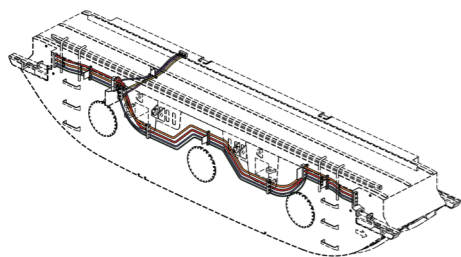

Hydraulic lines are fully embedded within the pontoon for protection against damage.

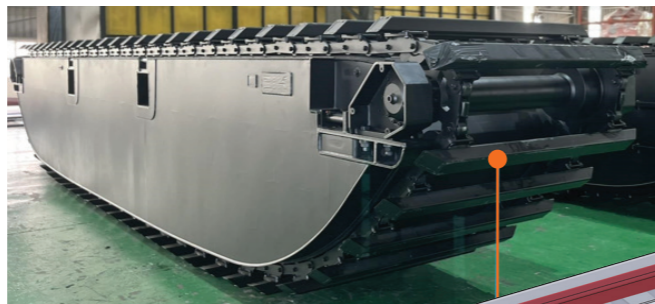

Rib-reinforced internal structure prevents deflection.



Epoxy paint coated exterior for greater corrosion resistance.

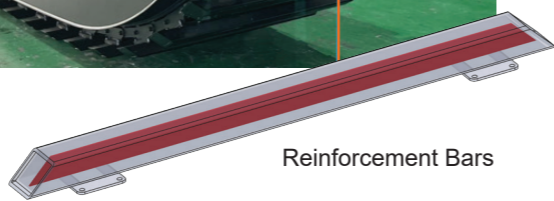

Reinforcement Bars

CENTER FRAME

- Embedded hydraulic cylinder design.
- Protection against external debris.
- Detachable ring design increased flexibility in removing the upper structure during maintenance.
- Extensively use of high strength steel.
- Increased structural rigidity and torsion resistant.
- Mechanical locking arms as a secondary safety feature to hold pontoons in position during operation.

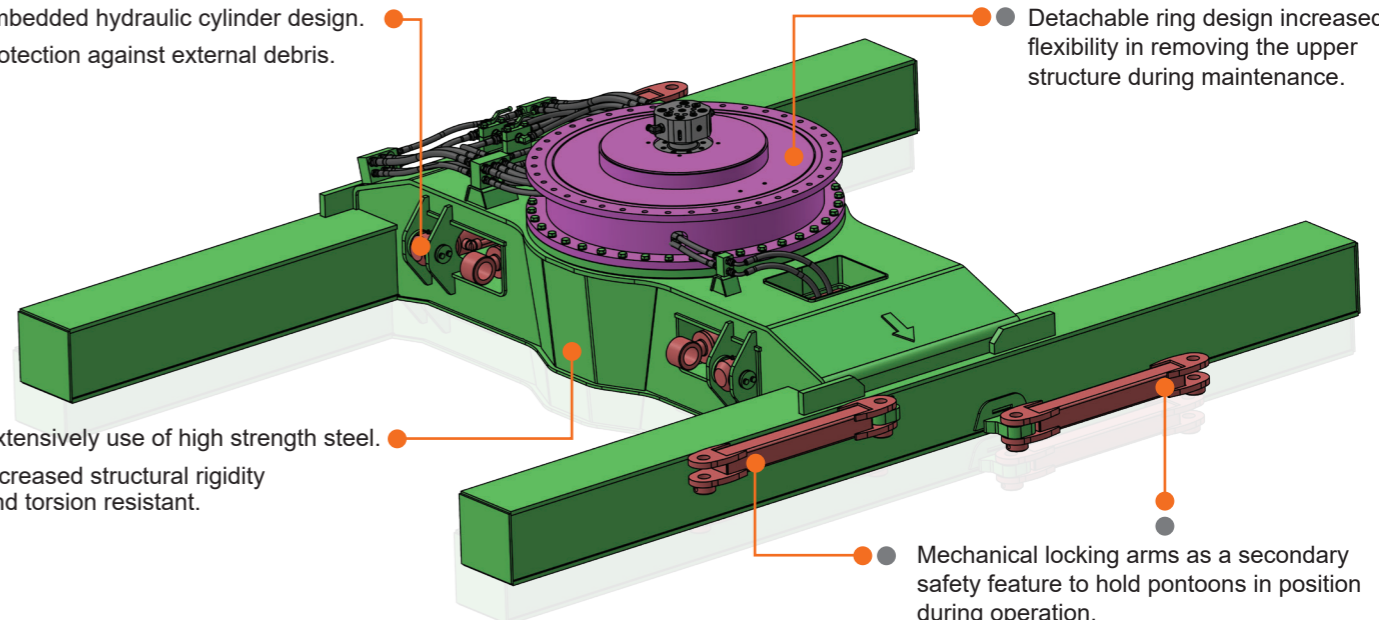

AMPHIBIOUS EXCAVATOR

INDUSTRY LEADING DESIGN AND FEATURE

ZX-5G Amphibious Excavator are designed to keep you ahead of the competition. Our cutting-edge track chain design, coupled with the strength of hardened steel components, ensures that your machine performs reliably in even the toughest environments - all while minimizing maintenance and operational costs. With state-of-the-art track chain and travel motor technologies, the ZX-5G amphibious provides you with unmatched performance. The new ZX-5G amphibious models offer key advantages such as superior quality and durability, ensuring low operational costs. This amphibious machine, driven by significant advancements, will help bring your vision and dreams to life while shaping a vibrant.

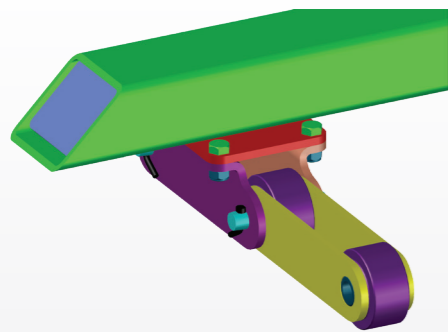

REVOLUTIONARY NEW TRACK CHAIN DESIGN

The track chain is a crucial component in any amphibious machine, and ZX-5G Amphibious machine has taken it to the next level with an all-new, innovative design. Our track chain is expertly engineered and manufactured to ensure complete quality control, providing you with the highest level of reliability and performance

BUILT FOR DURABILITY WITH HARDENED STEEL

At ZX-5G Amphibious, we prioritize strength and longevity. That's why we've crafted our track chain components—pins, bushings, and rollers—from hardened steel. This results in significantly improved durability, reducing wear and tear over time and ensuring low maintenance.

STRENGTH & LONGEVITY YOU CAN RELY ON

Our advanced track chain design offers exceptional strength and durability, so you won't need to worry about frequent replacements. This translates to a lower total cost of ownership, giving you more value over the long term while keeping your operation running smoothly with minimal downtime.



SAFE & CONVENIENT PONTOON ACCESS

The pontoon is equipped with a handrail and step system designed to make accessing the cabin easier and safer. Positioned on the side of the pontoon, these features allow the operator to climb onto the pontoon and enter the cabin with ease, enhancing overall safety and convenience during operation.



SLEEK, IMPROVED MOTOR COVER

The improved motor cover is seamlessly flushed with the side pontoon, providing a sleek and protective design. Hydraulic hoses are fully concealed and protected, minimizing the risk of damage and ensuring smooth operation. Additionally, the new design reduces the chance of debris trapping, maintaining optimal performance and minimizing downtime for maintenance.



STRONGER, LIGHTER, LONGER-LASTING SPROCKETS

The new sprocket design offers significant improvements in both strength and weight, making it lighter yet stronger than ever before. With a 100% increase in steel strength and a 100% improvement in wear resistance, the new sprocket is built to withstand the toughest conditions and last longer, reducing the frequency of maintenance. These innovations lead to reduced maintenance cycles and lower operating costs, ensuring your amphibious machine delivers maximum performance with minimum downtime.

SPECIFICATIONS

ZX130-5G AMPHIBIOUS

ENGINE

Model	Isuzu CC-4BG1T
Type	4-cycle water-cooled, direct injection
Aspiration	Turbocharged, intercooled
No. of cylinders	4
Rated power	
ISO 9249, net	67 kW (90 HP) at 2 150 min-1 (rpm)
SAE J1349, net	67 kW (90 HP) at 2 100 min-1 (rpm)
Maximum torque	347 Nm (35.4 kgfm) at 1 600 min-1 (rpm)
Piston displacement	4.329 L
Bore and stroke	105 mm x 125 mm
Batteries	2 x 12 V / 55 Ah

HYDRAULIC SYSTEM

Hydraulic Pumps

Main pumps	2 variable displacement axial piston pumps
Maximum oil flow	2 x 116 L/min
Pilot pump	1 gear pump
Maximum oil flow	36.1 L/min

Hydraulic Motors

Travel	4 variable displacement axial piston motors
Swing	1 axial piston motor

Relief Valve Settings

Implement circuit	34.3 MPa (350 kgf/cm ²)
Swing circuit	32.3 MPa (330 kgf/cm ²)
Travel circuit	34.3 MPa (350 kgf/cm ²)
Pilot circuit	4.0 MPa (41 kgf/cm ²)
Power boost	36.3 MPa (370 kgf/cm ²)

Hydraulic Cylinders

	Quantity	Bore	Rod Diameter
Boom	2	105 mm	70 mm
Arm	1	115 mm	80 mm
Bucket	1	100 mm	70 mm

UPPERSTRUCTURE

Revolving Frame

D-section frame skirt for resistance to deformation.

Swing Device

Swash plate piston motor with planetary reduction gear is bathed in oil.

Swing circle is single-row. Swing parking brake is spring-set/hydraulic-released disc type.

Swing speed 13.7 min⁻¹ (rpm)

Swing torque 34 kNm (3 470 kgfm)

Operator's Cab

Independent spacious cab, 1 005 mm wide by 1 675 mm high, conforming to ISO* Standards.

* International Organization for Standardization

UNDERCARRIAGE

The special undercarriage, fitted with square hollow steel shoes and floating seal rollers, gives exceptional mobility on wetland and swamps. It boosts buoyancy and ruggedness too. The machine can be easily knocked down for quick transport to the next job site, as the upperstructure is bolted to the undercarriage through the support beam, and hydraulic piping employs quick couplers.

Numbers of Shoes and Float Capacity on Each Side

Type steel track shoes	53
Float capacity	13 500 kg

Travel Device

The new sprocket is lighter and stronger, with improved durability.

Hardened steel parts reduce maintenance and costs, while the strong track chain lowers overall ownership expenses.

Travel speeds	0 to 2.4 km/h (Low)
	0 to 3.6 km/h (High)

Maximum traction force 165 kN (16 878 kgf)

Gradeability	17% (10 degree) water conditions
	57% (30 degree) ground conditions

UNDERCARRIAGE

Fuel tank	280.0 L
Engine coolant	19.0 L
Engine oil	15.8 L
Swing device	3.2 L
Travel device (each motor)	1.3 L
Hydraulic system	170.0 L
Hydraulic oil tank	70.0 L

WEIGHTS AND GROUND PRESSURE

Equipped with 7.30 m boom, 4.70 m arm and 0.35 m³ bucket (SAE heaped).

Shoe type	Shoe width	Operating weight	Ground pressure
Box type steel	1 450 mm	25 100 kg	11 kPa (0.12 kgf/cm ²)

BACKHOE ATTACHMENTS

Boom and arms are of welded, box-section design. 7.30 m boom, 4.70 m arm is available. Bucket is of welded steel structure. Side clearance adjust mechanism provided on the bucket joint bracket.

Buckets

Capacity ISO heaped	Width Without side cutters	No. of teeth	Weight
0.35 m ³	840 mm	4	375 kg

WORKING RANGE

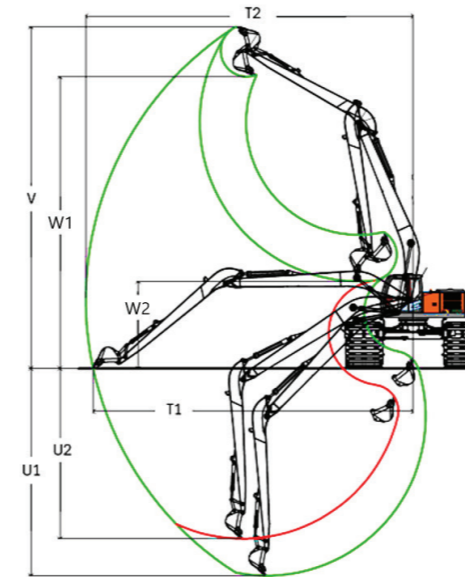

Unit: mm

Model	ZX 130-5G Amphibious
T1	Max. digging reach (on ground) 12 240
T2	Max. digging reach 12 480
U1	Max. digging depth from front 8 440
U2	Max. digging depth from side 7 030
V	Max. cutting height 12 620
W1	Max. dumping height 10 380
W2	Min. dumping height 3 520

Notes

- The ZX130-5G AMPHIBIOUS is not a ship. It is not fitted with equipment for cruising or working on water.
- The ZX130-5G AMPHIBIOUS is designed for working on soft ground. Working or traveling on hard and rough ground is prohibited.
- Avoid operating with machine floating on water.

Never attempt to work with the machine floating on water. Failure to do so may result in overturning of the machine.

DIMENSION

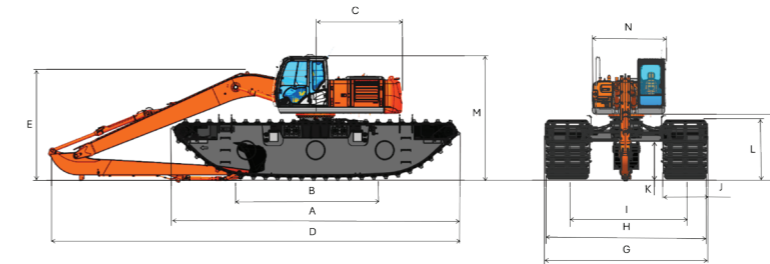

Unit: mm

Model	ZX 130-5G Amphibious
A	Max. track length 9 290
B	Track length on ground 4 500
C	Rear upperstructure length 2 190
D	Overall length 12 630
E	Height of the boom 3 150
F	Upperstructure clearance 1 840
G	Overall width (min/max) 4 020 / 5 120
H	Track width (min/max) 3 940 / 5 040
I	Track gauge (min/max) 2 490 / 3 590
J	Pontoon width 1 450
K	Max. Ground clearance 1 120
L	Track height 1 690
M	Overall cab height 3 880
N	Upperstructure overall width 2 490

TRANSPORTATION

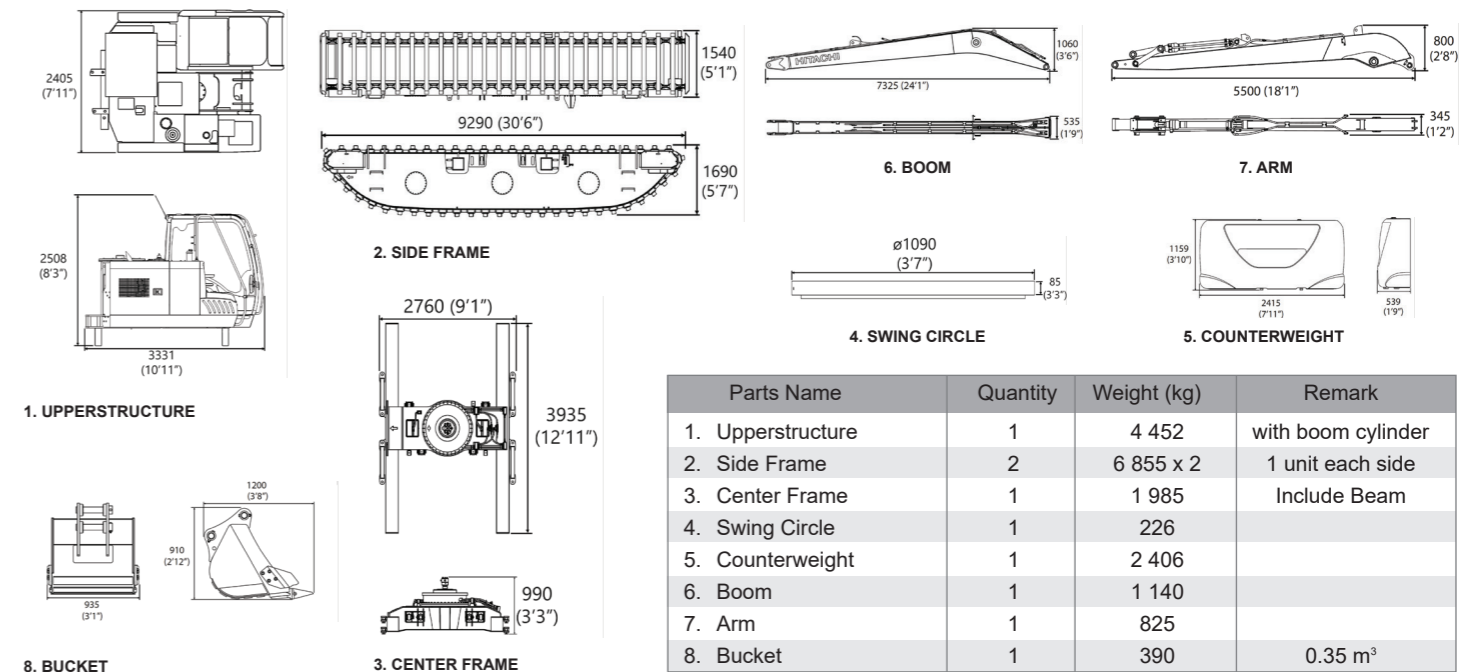

Parts Name	Quantity	Weight (kg)	Remark
1. Upperstructure	1	4 452	with boom cylinder
2. Side Frame	2	6 855 x 2	1 unit each side
3. Center Frame	1	1 985	Include Beam
4. Swing Circle	1	226	
5. Counterweight	1	2 406	
6. Boom	1	1 140	
7. Arm	1	825	
8. Bucket	1	390	0.35 m ³

SPECIFICATIONS

ZX200-5G AMPHIBIOUS

ENGINE

Model	Isuzu CC-6BG1T
Type	4-cycle water-cooled, direct injection
Aspiration	Turbocharged, intercooled
No. of cylinders	6
Rated power	
ISO 9249, net	125 kW (168 HP) at 2 100 min ⁻¹ (rpm)
SAE J1349, net	125 kW (168 HP) at 2 100 min ⁻¹ (rpm)
Maximum torque	637 Nm (65 kgfm) at 1 800 min ⁻¹ (rpm)
Piston displacement	6.494 L
Bore and stroke	105 mm x 125 mm
Batteries	2 x 12 V / 88 Ah

HYDRAULIC SYSTEM

Hydraulic Pumps

Main pumps	2 variable displacement axial piston pumps
Maximum oil flow	2 x 212 L/min
Pilot pump	1 gear pump
Maximum oil flow	33.6 L/min

Hydraulic Motors

Travel	4 variable displacement axial piston motors
Swing	1 axial piston motor

Relief Valve Settings

Implement circuit	34.3 MPa (350 kgf/cm ²)
Swing circuit	34.3 MPa (350 kgf/cm ²)
Travel circuit	34.3 MPa (350 kgf/cm ²)
Pilot circuit	3.9 MPa (40 kgf/cm ²)
Power boost	38.0 MPa (388 kgf/cm ²)

Hydraulic Cylinders

	Quantity	Bore	Rod Diameter
Boom	2	120 mm	85 mm
Arm	1	135 mm	95 mm
Bucket	1	100 mm	70 mm

UPPERSTRUCTURE

Revolving Frame

D-section frame skirt for resistance to deformation.

Swing Device

Axial piston motor with planetary reduction gear is bathed in oil.

Swing circle is single-row. Swing parking brake is spring-set/hydraulic-released disc type.

Swing speed	13.5 min ⁻¹ (rpm)
Swing torque	68 kNm (6 900 kgfm)

Operator's Cab

Independent spacious cab, 1 005 mm wide by 1 675 mm high, conforming to ISO* Standards.

* International Organization for Standardization

SPECIFICATIONS

UNDERCARRIAGE

The special undercarriage, fitted with square hollow steel shoes and floating seal rollers, gives exceptional mobility on wetland and swamps. It boosts buoyancy and ruggedness too. The machine can be easily knocked down for quick transport to the next job site, as the upperstructure is bolted to the undercarriage through the support beam, and hydraulic piping employs quick couplers.

Numbers of Shoes and Float Capacity on Each Side

Type steel track shoes	50
Float capacity	18 750 kg

Travel Device

The new sprocket is lighter and stronger, with improved durability. Hardened steel parts reduce maintenance and costs, while the strong track chain lowers overall ownership expenses.

Travel speeds	0 to 2.4 km/h (Low)
	0 to 3.6 km/h (High)

Maximum traction force..... 308 kN (31 418 kgf)

Gradeability	17% (10 degree) water conditions
	57% (30 degree) ground conditions

UNDERCARRIAGE

Fuel tank	400.0 L
Engine coolant	23.0 L
Engine oil	25.0 L
Swing device	6.2 L
Travel device (each motor)	3.0 L
Hydraulic system	240.0 L
Hydraulic oil tank	135.0 L

WEIGHTS AND GROUND PRESSURE

Equipped with 8.1 m boom, 5.83 m arm and 0.50 m³ bucket (SAE heaped).

Shoe type	Shoe width	Operating weight	Ground pressure
Box type steel	1 620 mm	33 700 kg	15.2 kPa (0.15 kgf/cm ²)

BACKHOE ATTACHMENTS

Boom and arms are of welded, box-section design. 8.28 m boom, 6.83 m arm is available. Bucket is of welded steel structure. Side clearance adjust mechanism provided on the bucket joint bracket.

Buckets

Capacity	Width	No. of teeth	Weight
ISO heaped	Without side cutters		
0.50 m ³	915 mm	4	445 kg

WORKING RANGE

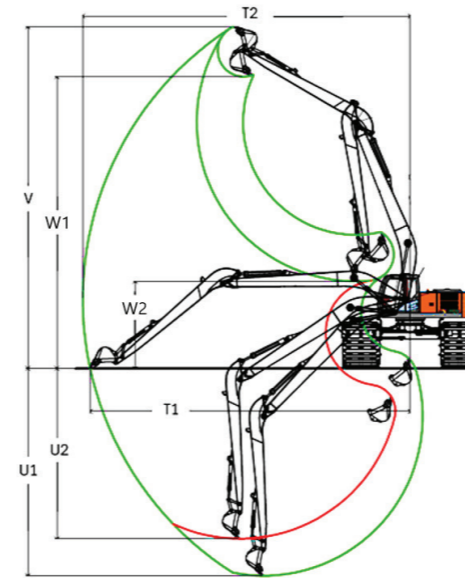

Model	ZX 130-5G Amphibious	
T1	Max. digging reach (on ground)	14 050
T2	Max. digging reach	14 380
U1	Max. digging depth from front	9 110
U2	Max. digging depth from side	7 450
V	Max. cutting height	15 000
W1	Max. dumping height	12 790
W2	Min. dumping height	3 820

Notes

- The ZX200-5G AMPHIBIOUS is not a ship. It is not fitted with equipment for cruising or working on water.
- The ZX200-5G AMPHIBIOUS is designed for working on soft ground. Working or traveling on hard and rough ground is prohibited.
- Avoid operating with machine floating on water.

Never attempt to work with the machine floating on water. Failure to do so may result in overturning of the machine.

DIMENSION

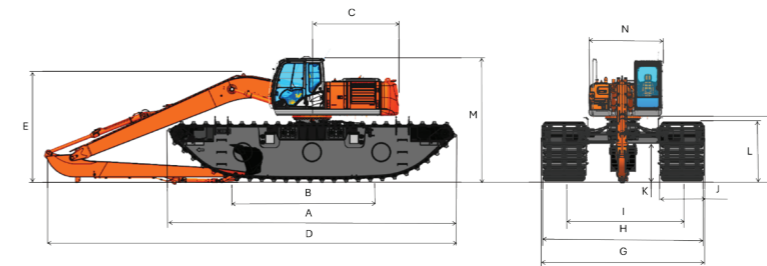

Model	ZX 200-5G Amphibious	
A	Max. track length	9 630
B	Track length on ground	4 500
C	Rear upperstructure length	2 890
D	Overall length	13 690
E	Height of the boom	3 470
F	Upperstructure clearance	2 220
G	Overall width (min/max)	4 500 / 5 980
H	Track width (min/max)	4 470 / 5 950
I	Track gauge (min/max)	2 850 / 4 330
J	Pontoon width	1 620
K	Max. Ground clearance	1 300
L	Track height	2 030
M	Overall cab height	4 100
N	Upperstructure overall width	2 710

TRANSPORTATION

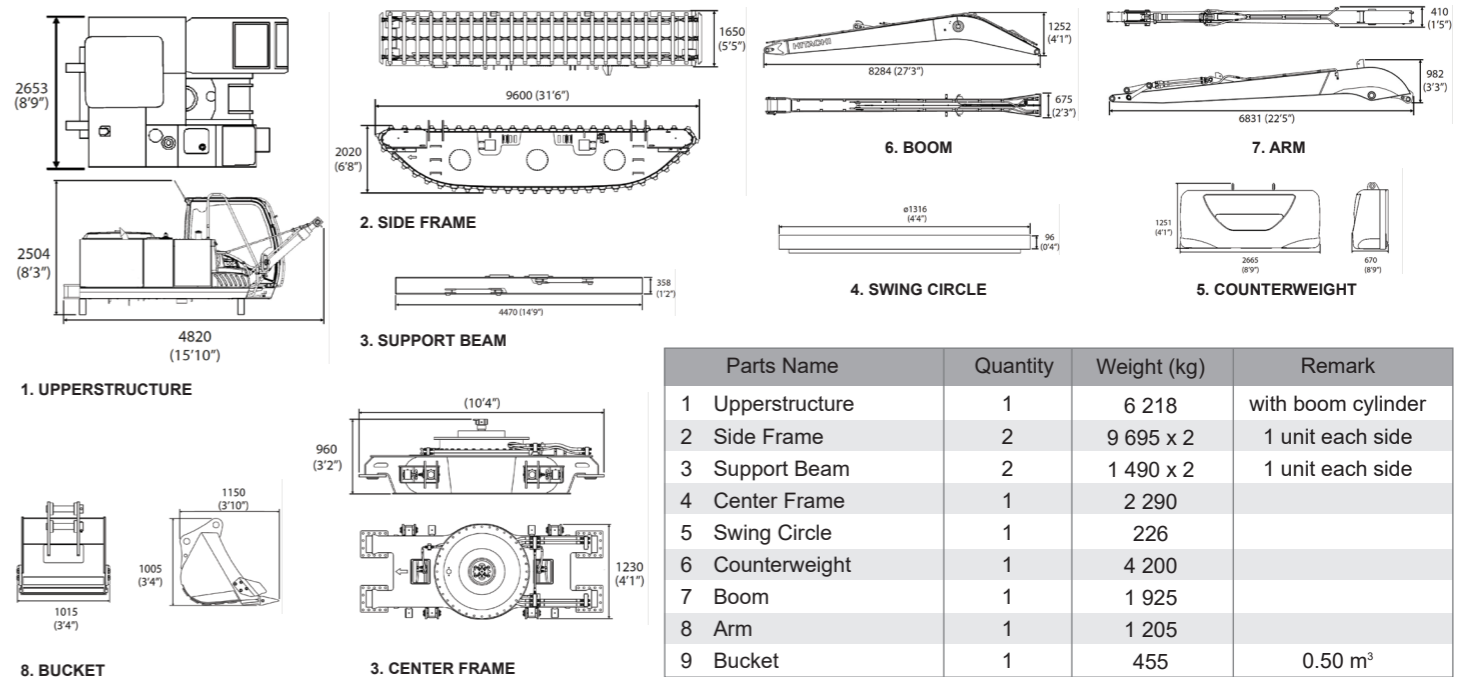

Parts Name	Quantity	Weight (kg)	Remark
1 Upperstructure	1	6 218	with boom cylinder
2 Side Frame	2	9 695 x 2	1 unit each side
3 Support Beam	2	1 490 x 2	1 unit each side
4 Center Frame	1	2 290	
5 Swing Circle	1	226	
6 Counterweight	1	4 200	
7 Boom	1	1 925	
8 Arm	1	1 205	
9 Bucket	1	455	0.50 m ³

SPECIFICATIONS

ZX240-5G AMPHIBIOUS

ENGINE

Model	Isuzu CC-6BG1T
Type	4-cycle water-cooled, direct injection
Aspiration	Turbocharged, intercooled
No. of cylinders	6
Rated power	
ISO 9249, net	132 kW (177 HP) at 2 150 min ⁻¹ (rpm)
SAE J1349, net	132 kW (177 HP) at 2 150 min ⁻¹ (rpm)
Maximum torque	637 Nm (65 kgfm) at 1 800 min ⁻¹ (rpm)
Piston displacement	6.494 L
Bore and stroke	105 mm x 125 mm
Batteries	2 x 12 V / 88 Ah

HYDRAULIC SYSTEM

Hydraulic Pumps

Main pumps	2 variable displacement axial piston pumps
Maximum oil flow	2 x 223 L/min
Pilot pump	1 gear pump
Maximum oil flow	32.0 L/min

Hydraulic Motors

Travel	4 variable displacement axial piston motors
Swing	1 axial piston motor

Relief Valve Settings

Implement circuit	34.3 MPa (350 kgf/cm ²)
Swing circuit	32.4 MPa (330 kgf/cm ²)
Travel circuit	34.8 MPa (355 kgf/cm ²)
Pilot circuit	3.9 MPa (40 kgf/cm ²)
Power boost	38.0 MPa (388 kgf/cm ²)

Hydraulic Cylinders

	Quantity	Bore	Rod Diameter
Boom	2	125 mm	90 mm
Arm	1	140 mm	100 mm
Bucket	1	110 mm	80 mm

UPPERSTRUCTURE

Revolving Frame

D-section frame skirt for resistance to deformation.

Swing Device

Axial piston motor with planetary reduction gear is bathed in oil.

Swing circle is single-row. Swing parking brake is spring-set/hydraulic-released disc type.

Swing speed 11.0 min⁻¹ (rpm)

Swing torque 77.5 kNm (7 900 kgfm)

Operator's Cab

Independent spacious cab, 1 005 mm wide by 1 675 mm high, conforming to ISO* Standards.

* International Organization for Standardization

UNDERCARRIAGE

The special undercarriage, fitted with square hollow steel shoes and floating seal rollers, gives exceptional mobility on wetland and swamps. It boosts buoyancy and ruggedness too. The machine can be easily knocked down for quick transport to the next job site, as the upperstructure is bolted to the undercarriage through the support beam, and hydraulic piping employs quick couplers.

Numbers of Shoes and Float Capacity on Each Side

Type steel track shoes	50
Float capacity	22 000 kg

Travel Device

The new sprocket is lighter and stronger, with improved durability. Hardened steel parts reduce maintenance and costs, while the strong track chain lowers overall ownership expenses.

Travel speeds	0 to 2.4 km/h (Low)
	0 to 3.6 km/h (High)

Maximum traction force 353 kN (36 015 kgf)

Gradeability	17% (10 degree) water conditions
	57% (30 degree) ground conditions

UNDERCARRIAGE

Fuel tank	510.0 L
Engine coolant	26.0 L
Engine oil	25.0 L
Swing device	9.1 L
Travel device (each motor)	3.0 L
Hydraulic system	280.0 L
Hydraulic oil tank	156.0 L

WEIGHTS AND GROUND PRESSURE

Equipped with 8.8 m boom, 6.14 m arm and 0.75 m³ bucket (SAE heaped).

Shoe type	Shoe width	Operating weight	Ground pressure
Box type steel	1 920 mm	42 600 kg	17 kPa (0.17 kgf/cm ²)

BACKHOE ATTACHMENTS

Boom and arms are of welded, box-section design. 8.8 m boom, 6.14 m arm is available. Bucket is of welded steel structure. Side clearance adjust mechanism provided on the bucket joint bracket.

Buckets

Capacity ISO heaped	Width Without side cutters	No. of teeth	Weight
0.75 m ³	1068 mm	4	690 kg

WORKING RANGE

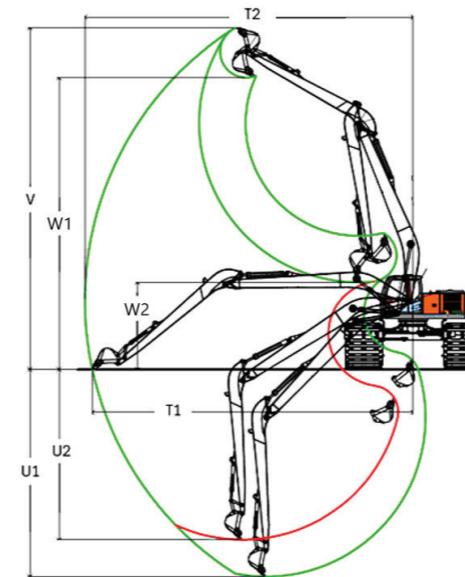

Model	ZX 240-5G Amphibious	
T2	Max. digging reach (On Ground)	15 290
T2	Max. digging reach	15 590
U1	Max. digging depth from Front	1 005
U2	Max. digging depth from side	7 870
V	Max. cutting Height	15 920
W1	Max. dumping height	13 290
W1	Min. swing Radius	3 910

Unit: mm

Notes

- The ZX240-5G AMPHIBIOUS is not a ship. It is not fitted with equipment for cruising or working on water.
- The ZX240-5G AMPHIBIOUS is designed for working on soft ground. Working or traveling on hard and rough ground is prohibited.
- Avoid operating with machine floating on water.

Never attempt to work with the machine floating on water. Failure to do so may result in overturning of the machine.

DIMENSION

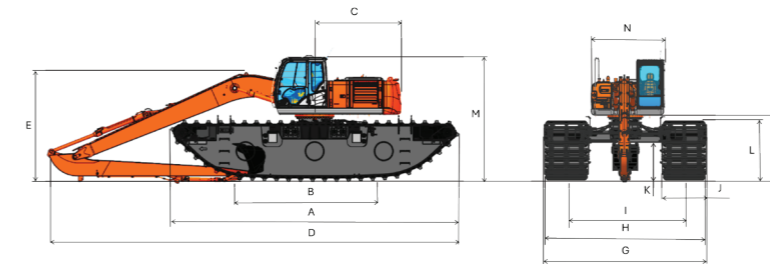

Unit: mm

Model	ZX 240-5G Amphibious	
A	Max. track length	9 630
B	Track length on ground	4 500
C	Rear upperstructure length	3 140
D	Overall length	14 660
E	Height of the boom	3 730
F	Upperstructure clearance	2 220
G	Overall width (min/max)	5 230/6 670
H	Track width (min/max)	5 200/6 640
I	Track gauge (min/max)	3 280/4 720
J	Pontoon width	1 920
K	Max. Ground clearance	1 290
L	Track height	2 020
M	Overall cab height	4 120
N	Upperstructure overall width	2 870

TRANSPORTATION

Parts Name	Quantity	Weight (kg)	Remark
1 Upperstructure	1	6 910	with boom cylinder
2 Side Frame	2	10 805 x 2	1 unit each side
3 Support Beam	2	1 810 x 2	1 unit each side
4 Center Frame	1	2 380	
5 Swing Circle	1	327	
6 Counterweight	1	5 250	
7 Boom	1	1 925	
8 Arm	1	1 205	
9 Bucket	1	690	0.75 m ³

EQUIPMENT

● : Standard equipment ○ : Optional equipment — : Not applicable

ENGINE	ZX130-5G	ZX200-5G	ZX240-5G
Air cleaner double filters	●	●	●
Auto idle system	●	●	●
Cartridge-type engine oil filter	●	●	●
Cartridge-type fuel pre-filter	●	●	●
Cartridge-type fuel main filter	●	●	●
Dry-type air filter with evacuator valve (with air filter restriction indicator)	●	●	●
ECO/PWR mode control	●	●	●
Engine Warm-up device	—	—	●
Fan guard	●	●	●
Water separator	●	●	●
Pre-cleaner	○	○	○
Dust-Proof indoor net	●	●	●
Radiator reserve tank	●	●	●
50 A alternator	●	●	●
Consite Oil (Sensor)	—	○	○

HYDRAULIC SYSTEM	ZX130-5G	ZX200-5G	ZX240-5G
Auto power lift	●	●	●
Control valve with main relief valve	●	●	●
Full flow filter	●	●	●
High mesh full flow filter with restriction indicator	○	○	○
Pilot filter	●	●	●
Power boost	●	●	●
Suction filter	●	●	●
One extra port for control valve	●	●	●
Work mode selector	●	●	●

CAB	ZX130-5G	ZX200-5G	ZX240-5G
All-weather sound suppressed steel cab	●	●	●
AM-FM radio with 2 speakers	●	●	●
Ashtray	●	●	●
Auto control air conditioner	○	●	●
AUX. Terminal and storage	—	○	○
Cab (Center pillar reinforced structure)	●	●	●
Drink holder	●	●	●
Drink holder with hot & cool	●	●	●
Electric double horn	●	●	●
Engine shut-off lever	●	●	●
Evacuation hammer	●	●	●
Fire extinguisher bracket	○	○	○
Floor mat	●	●	●
Footrest	●	●	●
Front window washer	●	●	●
Front windows on upper, lower and left side can be opened	●	●	●
Lower cab front guard	○	○	○
Upper cab front guard	○	○	○
Glove compartment	●	●	●
Hot & cool box	●	●	●
Intermittent windshield wipers	●	●	●
Key cilinder light	—	●	●
K-cab (Cab with overhead window & guard)	—	—	—
LED room light with door courtesy	●	●	●
OPG top guard Level I (ISO10262) compliant cab	●	●	●
Pilot control shut-off lever	●	●	●
Rear tray	●	●	●
Retractable seat belt	●	●	●
Rubber radio antenna	●	●	●
ROPS (ISO12117-2:2008) compliant cab	○	—	—
Seat : Fabric seat	●	●	●
Seat : mechanical suspension seat	○	○	○
Seat : air suspension seat with heater	○	○	○
Seat adjustment part : backrest, armrest, height and angle, slide forward / back	●	●	●
Short wrist control levers	●	●	●
Twin wiper	—	—	—
4 fluid-filled elastic mounts	●	●	●
24V cigarette lighter	●	●	●
Right Pedal for Hydraulic Extendable Pontoon	●	●	●

MONITOR SYSTEM	ZX130-5G	ZX200-5G	ZX240-5G
Alarms: overheat, engine warning, engine oil pressure, alternator, minimum fuel level, hydraulic filter restriction, air filter restriction, etc	●	—	—
Alarms: overheat, engine warning, engine oil pressure, alternator, minimum fuel level, hydraulic filter restriction, air filter restriction, air filter restriction, work mode, overload, etc	—	●	●
Alarm buzzers: overheat, engine oil pressure	●	●	●
Display of meters: coolant temperature, hour, clock, etc	●	●	●
Other displays: work mode, auto-idle, glow, operating conditions, etc.	●	●	●
Other displays: work mode, auto-idle, glow, rear view monitor, operating conditions, etc	—	●	●
32 languages selection	—	●	●

LIGHTS	ZX130-5G	ZX200-5G	ZX240-5G
Additional cab roof front lights	○	○	○
Additional boom lights with cover	○	○	○
2 working lights	●	●	●

UPPER STRUCTURE	ZX130-5G	ZX200-5G	ZX240-5G
Electric fuel refilling pump	○	○	○
Fuel level float	●	●	●
Gap filled radiator	●	—	—
Hydraulic oil level gauge	●	●	●
Rear view camera	○	○	○
Rear view mirror (Right & left side)	●	●	●
Swing parking brake	●	●	●
Tool box	●	●	●
Tropical cover	●	●	●
Undercover	●	●	●
6.0 mm reinforced undercover	○	○	○
Utility space	—	●	●
2 400 kg counterweight	●	—	●
4 200 kg counterweight	—	●	—
4 600 kg counterweight	—	○	—
5 400 kg counterweight	—	○	—
5 250 kg counterweight	—	—	●
5 900 kg counterweight	—	—	○
6 300 kg counterweight	—	—	○
2 x 55 Ah batteries	●	—	—
2 x 88 Ah batteries	—	●	●

EQUIPMENT

● : Standard equipment ○ : Optional equipment — : Not applicable

UNDERCARRIAGE	ZX130-5G	ZX200-5G	ZX240-5G
Bolt-on travel motor	●	●	●
Greasing type track adjuster	●	●	●
Track chain with roller and cotter pin	●	●	●
Reinforcement track shoe	●	●	●
Track guide and wear strip	●	●	●
2 ties lifting point (Ear type)	●	●	●
2 ties lifting point (pin type)	●	●	●
Handrail	●	●	●
Travel motor covers	●	●	●
Bottom cover center platform	●	●	●
Travel direction mark on track frame	●	●	●
Travel parking brake	●	●	●
Mechanical Extendable	—	○	○
Hydraulic extendable	●	●	●
Hydraulic extendable with Additional pontoon and spud system	○	○	○
Fixation system/ linkage	●	●	●

FRONT ATTACHMENTS	ZX130-5G	ZX200-5G	ZX240-5G
Centralized lubrication system	●	●	●
Flanged pin	●	●	●
HN bushing	●	●	●
Arm 4.70 m	●	—	—
Boom 7.30 m	●	—	—
Bucket 0.35 m3 (SAE : heaped) Standard Tooth	●	—	—
Arm 5.83 m	—	●	—
Boom 8.10 m	—	●	—
Bucket 0.5 m3 (SAE : heaped) Standard Tooth	—	●	—
Arm 6.14 m	—	—	●
Boom 8.8 m	—	—	●
Bucket 0.7 m3 (SAE : heaped) Standard Tooth	—	—	●

ATTACHMENTS	ZX130-5G	ZX200-5G	ZX240-5G
High mesh full flow filter with restriction indicator	○	○	○
Attachment basic piping for Upper Structure (Right Pedal for Extendable Pontoon)	●	●	●

MISCELLANEOUS	ZX130-5G	ZX200-5G	ZX240-5G
Lockable fuel refilling cap	●	●	●
Lockable machine covers	●	●	●
Onboard information controller	●	●	●
Skid resistant tapes, plates and handrails	●	●	●
Standard tool kit	●	●	●
Global e-Service	●	●	●

Standard and optional equipment may vary by country, so please consult authorized dealer for details.

* Engine oil and hydraulic oil monitoring

Before using a machine with a satellite or tele-communication system, please make sure that the satellite or tele-communication system complies with local regulations, safety standards and legal requirements. If not so, please make modifications accordingly.

These specifications are subject to change without notice.

Illustrations and photos show the standard models, and may or may not include optional equipment, accessories, and all standard equipment with some differences in color and features.

Before use, read and understand the Operator's Manual for proper operation.